

Lux-May exclusive Range **DLUX RECESSED DOWNLIGHTS**

DLUXT/F-IP44



High quality, compact Design, horizontal position for lamps TC-D/TC-DEL.

LUMINAIRE HOUSING: Made of polycarbonate. White flange ring made in die-cast aluminium finished with electrostatic powder coating RAL 9010. The ring is attached to the body using a twist at the three points of fixation, which allows fast replacement for lamps even if glass cover or decorative accessories are used.

WIELAND connector is optional.

According to Norm ENEC-10/VDE.

OPTIC: High specular faceted polished reflector made of pure aluminium, silver coated by vapour deposition.

Reflector is precision formed to render very high light efficiency.

DLUXT/F-IP44: Transparent glass included

* This range "DLUX" is only supplied with electronic ballasts.



Possibility of conector wieland or similar



Dimensions

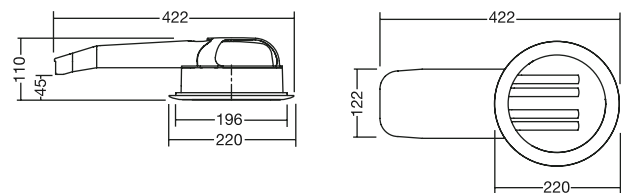

Mounting



| | Lamp. |
|---|----------------|
| exclusive DLUXT/F-IP44 - 1x13W - 230V H.F. | TC-DEL, TC-TEL |
| exclusive DLUXT/F-IP44 - 1x18W - 230V H.F. | TC-DEL, TC-TEL |
| exclusive DLUXT/F-IP44 - 1x26W - 230V H.F. | TC-TEL |
| exclusive DLUXT/F-IP44 - 1x32W - 230V H.F. | TC-TEL |
| exclusive DLUXT/F-IP44 - 2x13W - 230V H.F. | TC-DEL, TC-TEL |
| exclusive DLUXT/F-IP44 - 2x18W - 230V H.F. | TC-DEL, TC-TEL |
| exclusive DLUXT/F-IP44 - 2x26W - 230V H.F. | TC-TEL |