

D



Compact Design, horizontal position for lamps TC-D/TC-DEL.

Open reflector for maximum output in luminous intensity.

LUMINAIRE HOUSING: Made of high quality 0,6 mm trimmed, galvanized steel sheet. White flange ring made in enamelled steel sheet with thermo-hardened UV resistant

powder coat. Installation using tension clips. WIELAND connector is optional.

According to Norm ENEC-10/VDE.

OPTIC: High specular polished reflector made of pure aluminium, silver coated by vapour deposition.

Reflector is precision formed to render very high light efficiency.

D-195 1x13 W.

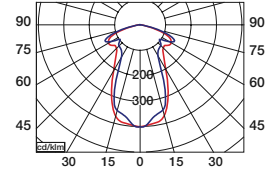

D-195

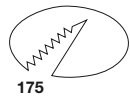
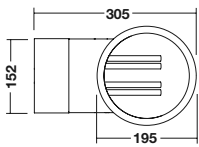
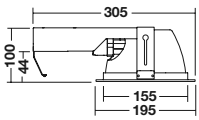

- D-195 - 1x13W - 230V
- D-195 - 1x18W - 230V
- D-195 - 1x26W - 230V
- D-195 - 2x13W - 230V
- D-195 - 2x18W - 230V
- D-195 - 2x26W - 230V



D-230

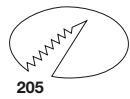
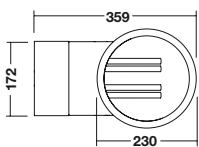
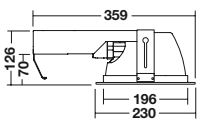

- D-230 - 1x32W - 230V - H.F.
- D-230 - 1x42W - 230V - H.F.
- D-230 - 2x32W - 230V - H.F.

